

AM-CL2532MAN SERIES

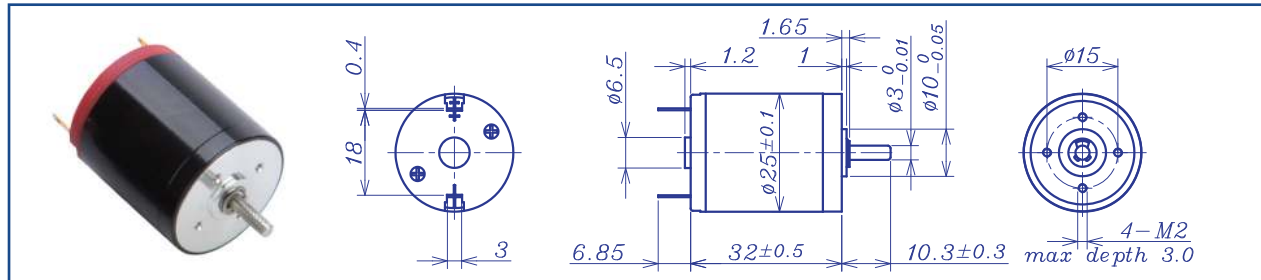

| | | Precious metal brush | | | | Ball bearings | | | | |
|--|------------------|----------------------|-------|-------|-------|---------------|-------|-------|-------|-------|
| Motor Model | | | 0306 | 0304 | 0606 | 0604 | 1206 | 1204 | 2406 | 2405 |
| Nominal voltage | | V | 3 | 3 | 6 | 6 | 12 | 12 | 24 | 24 |
| No load speed ±12% | | rpm | 6010 | 3993 | 6073 | 4155 | 6592 | 4070 | 6166 | 4850 |
| No load current Max 150% | | mA | 120 | 74 | 53 | 37 | 24 | 20 | 15 | 9.5 |
| Recommend limit for continuous operation | Max cont. torque | mN.m | 3.9 | 6.2 | 6.0 | 7.6 | 6.5 | 7.7 | 7.5 | 11.2 |
| | Rated speed | rpm | 5420 | 3162 | 5279 | 3125 | 5717 | 3035 | 5110 | 3315 |
| | Rated current | mA | 950 | 950 | 700 | 600 | 400 | 300 | 220 | 250 |
| | Rated power | W | 2.2 | 2.0 | 3.3 | 2.5 | 3.9 | 2.5 | 4.0 | 3.9 |
| Starting current | | mA | 8571 | 4286 | 5000 | 2308 | 2857 | 1121 | 1212 | 769 |
| Stall torque | | mN.m | 40 | 30 | 46 | 31 | 49 | 30 | 44 | 35 |
| Maximum power output | | W | 6.2 | 3.1 | 7.3 | 3.4 | 8.4 | 3.2 | 7.1 | 4.5 |
| Maximum efficiency | | % | 78 | 75 | 80 | 76 | 83 | 75 | 79 | 79 |
| Terminal resistance ±12% | | Ω | 0.35 | 0.7 | 1.2 | 2.6 | 4.2 | 10.7 | 19.8 | 31.2 |
| Inductance (1KHZ) | | mH | 0.014 | 0.048 | 0.086 | 0.02 | 0.34 | 0.87 | 1.48 | 2.36 |
| Mechanical time constant | | ms | 17.1 | 14.8 | 13.9 | 15.0 | 14.4 | 14.1 | 14.8 | 13.3 |
| Moment of inertia | | gcm ² | 10.8 | 10.5 | 10.1 | 10.6 | 10.2 | 10.1 | 10.1 | 9.28 |
| Torque constant | | mN.m/A | 4.7 | 7.1 | 9.3 | 13.6 | 17.2 | 27.7 | 36.7 | 46.7 |
| Speed constant | | rpm/V | 2032 | 1354 | 1023 | 704 | 554 | 345 | 260 | 205 |
| Speed/torque gradient | | rpm/mN.m | 151.3 | 134.5 | 131.5 | 134.9 | 135.0 | 133.6 | 140.3 | 136.8 |
| Weight | | g | 73.3 | 72.9 | 72.4 | 73.0 | 72.6 | 72.4 | 72.4 | 72.2 |

ADDITIONAL INFORMATION

| | | | |
|---|----------|--|-------------|
| Motor thermal resistance: | 16.6 K/W | Motor thermal time constant: | 780 S |
| Axial (dynamic): | 7.3 N | Radial (5mm from mounting face): | 8.0N |
| Press-fit force (static): | 16(120)N | Max allowable screw depth into flange: | 3.0mm |
| Maximum radial play (5mm from mounting face): | ≤0.02 mm | Axial play | Preset |
| Maximum winding temperature: | 85°C | Ambient temperature range: | -30 to °C65 |
| Standard rear shaft diameter: | 1.5 mm | Standard rear shaft length "L": | 0/3.7 mm |

| Total Length (Gearbox and Motor): L _T =L1+L2+L3 | | | |
|--|----------|---------|-----------|
| L1:24GP | L1: 28GP | L2:CL25 | L3: EN16S |
| 22.2 | 25.9 | 32.0 | 10.7 |
| 27.4 | 33.1 | | |
| 32.6 | 40.3 | | |

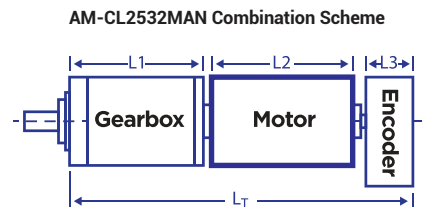

Recommended Gearbox: Planetary Gearbox: AM-24GP, AM-28GP
Recommended Encoder: Encoder S: AM-EN1611S*** 2~3 Channels

For more combination specs, visit Assun Motor website.

Remarks: Client can choose gearbox and encoder to match with this motor. Some combinations are listed here for reference.

Motor data tested at 25°C. Motor operation exceeding continuous limits will reduce life or result in damage. At elevated ambient temperatures, load current must be reduced.

Download datasheet: <https://assunmotor.com/documents-download>

Visit Our Website and Online Shop at <https://assunmotor.com> Contact: info@assunmotor.com