

Miniatur Axial Gebläse mit externer Elektronik
Miniature Axial fan with external electronic

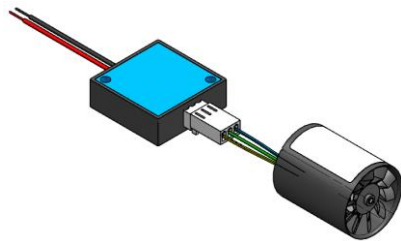

D241L-006KH-5
D241L-012KH-5

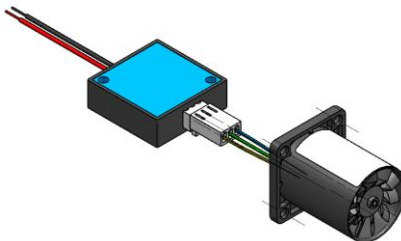

D243L-006KH-5
D243L-012KH-5

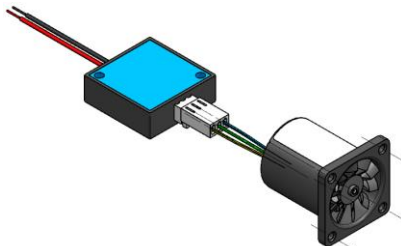

D244L-006KH-5
D244L-012KH-5

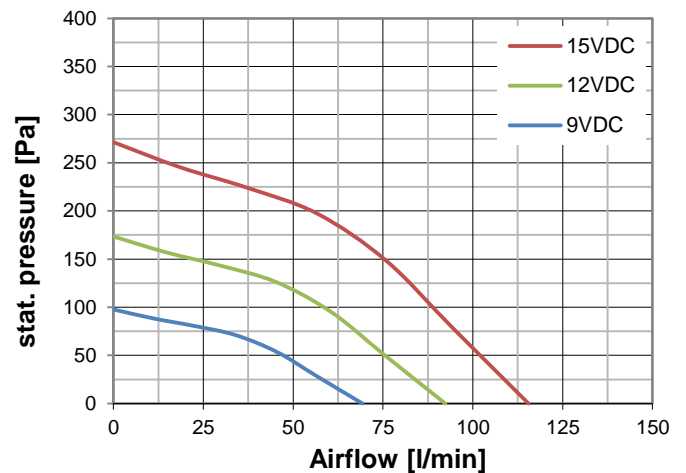
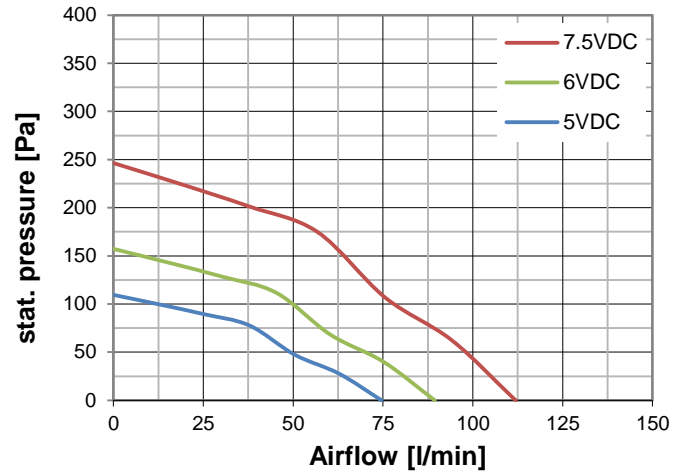

6V Version

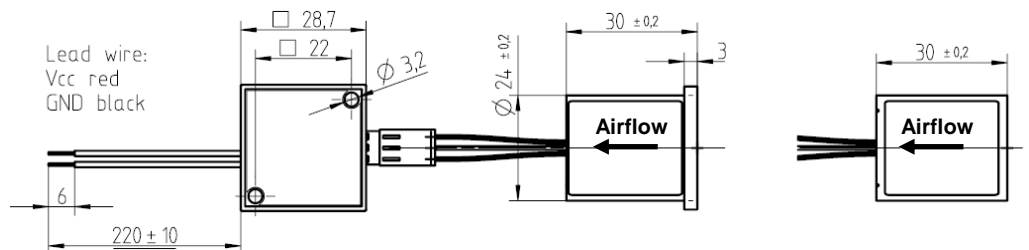
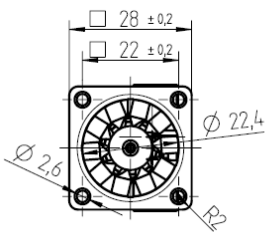

12V Version

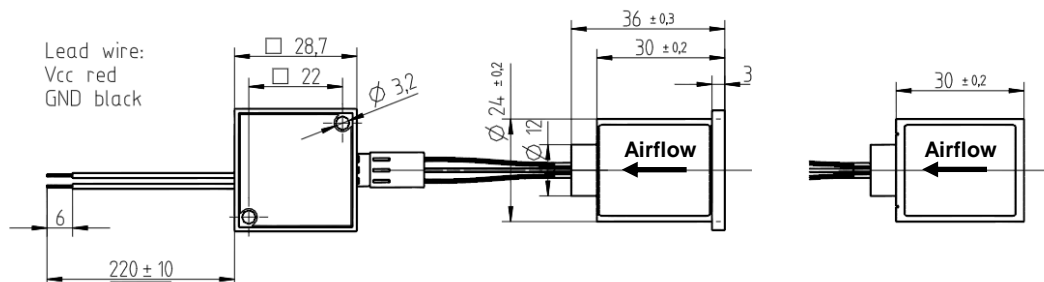
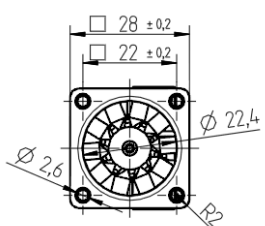

Technische Daten

Allgemeine Beschreibung

Lüfter mit grossem Volumenstrom, wirtschaftlichem Motor und externer Power-Elektronik.

Eigenschaften: Material: Gehäuse: PPO, Flügelrad: PPO.

Elektronisch kommutierter Motor.

Optional: Tacho, Set speed und NTC

Technical data

General description

Fan with a high airflow, economic motor and external power electronic.

Features: Material: Housing: PPO, Impeller: PPO

Electronically commutated motor

Options: Tacho, Set speed and NTC

		D24.L-006KH-5	D24.L-012KH-5
U_N	VDC	6	12
U	VDC	5 - 7.5	9 – 15
I_N freeblowing	mA	120	115
I_N work. point	mA	145	130
I_N static	mA	140	125
P_N work. point	W	0.9	1.55
n freeblowing	min ⁻¹	20'500	21'150
n work. point	min ⁻¹	20'000	21'020
n static	min ⁻¹	20'130	21'070
V freeblowing	l/min	90	90
V work. point	l/min	45	45
p work. point	Pa	110	125
p static	Pa	160	170
$LpA_{(WP)}$	dB(A)	47.4	48.7
T	°C	-40...+85	
m	gr	29	
Leads	mm	220 (AWG26)	Leads
Housing Material	PPO UL94V-1		
Ball Bearing	•		
Tacho	optional		optional
Set speed	optional		optional
NTC	optional		optional

Data's at Density: 1.2kg/m³

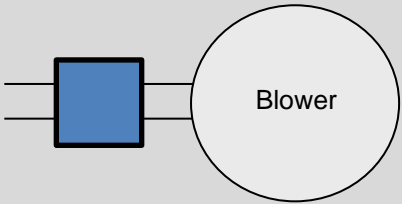
		D24.L-...KH-5	
Electrical circuit	Description	Lead wire	Diagram
	Vcc + Power GND Ground	red black	

Electrical features

D24.L-006KH-5

No polarity protection

D24.L-012KH-5

polarity protection
 Overvoltage protection: maximum 28VDC
 Input protected by suppresser diode



**Exceeding the blower limits during continuous operation may cause permanent damage!
 Handle only in currentless condition!**

Power supply requirements

Ripple voltage < 5%,

Info

**Specifications are subject to change without notice.
 Specifications on this Datasheet are for reference.**

Version: 07.06.2016 / DH

Doc: D240_ext_Elo high speed.docx