

AM-BS1204-201-36GP Series

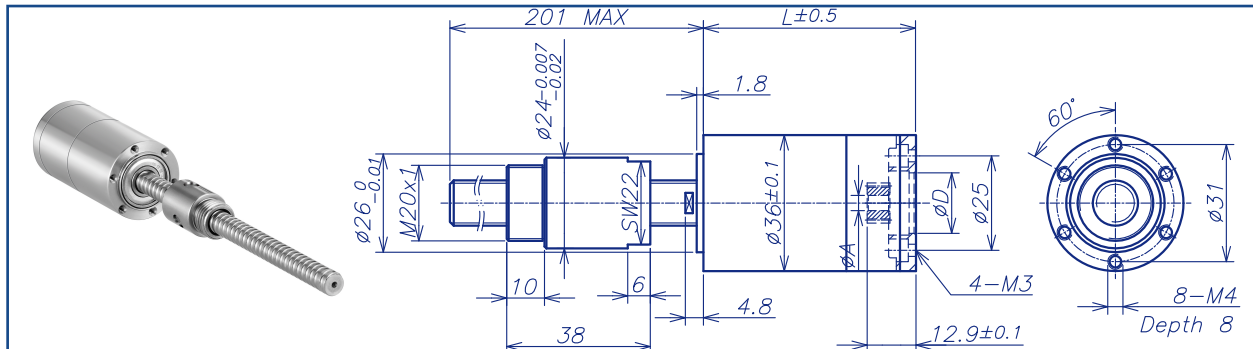

SCREW CHARACTER

Screw	$\phi 12 \times 4$, GCr15, hardened	Radial play (5mm from flange)	< 0.05mm				
Standard length	201mm	Axial play	preloaded				
Special length (5mm steps)	Max.600mm	Max.continuous input speed	8000rpm				
Nut (standard)	thread nut	Recommended Temperature Range	-40°C ~ +100°C				
Material	15CrMo, hardened	Max.axial load(static)	5700N				
Axial play	< 0.01mm	Number of stages	0	1	2	3	4
Planetary	straight teeth	Max. radial load: (15mm from flange)	360N	440N	660N	700N	700N
Bearing	ball bearing/thrust ball bearing						

SCREW DRIVE DATA

Reduction	1:1	3.5:1	12:1	36:1	43:1	91:1	285:1	546:1
Absolute reduction	1/1	7/2	49/4	36/1	343/8	91/1	15379/54	546/1
Max.feed velocity (mm/s)	266.7	152.4	43.5	14.8	12.4	5.9	1.9	1
Max.feed force (continuous) (N)	487	538	816	1170	1240	1593	2331	2896
Max.feed force (intermittent) (N)	1219	1346	2042	2925	3100	3984	5700	5700
Max. Gear Hole "A"	6	6	6	4	6	6	6	6
Reduction		4.3:1	15:1		53:1	113:1	353:1	676:1
Absolute reduction		13/3	91/6		637/12	338/3	28561/81	676/1
Max.feed velocity (mm/s)		123.1	35.2		10	4.7	1.54	0.8
Max.feed force (continuous) (N)		577	877		1331	1711	2503	3109
Max.feed force (intermittent) (N)		1444	2192		3329	4278	5700	5700
Max. Gear Hole "A"		6	6		6	4	6	6
Reduction		6:1	19:1		66:1	126:1	394:1	756:1
Absolute reduction		6/1	169/9		1183/18	126/1	1183/3	756/1
Max.feed velocity (mm/s)		88.9	28.4		8.1	4.2	1.4	0.7
Max.feed force (continuous) (N)		643	941		1430	1776	2598	3228
Max.feed force (intermittent) (N)		1609	2354		3575	4441	5700	5700
Max. Gear Hole "A"		4	6		6	6	6	6
Reduction			21:1		74:1	156:1	441:1	936:1
Absolute reduction			21/1		147/2	156/1	441/1	936/1
Max.feed velocity (mm/s)			25.4		7.3	3.4	1.2	0.6
Max.feed force (continuous) (N)			977		1484	1907	2697	3466
Max.feed force (intermittent) (N)			1955		3710	4768	5700	5700
Max. Gear Hole "A"			6		6	6	6	6
Reduction			26:1		81:1	216:1	488:1	1296:1
Absolute reduction			26/1		2197/27	216/1	4394/9	1296/1
Max.feed velocity (mm/s)			20.5		6.6	2.5	1.1	0.4
Max.feed force (continuous) (N)			1049		1535	2126	2790	3863
Max.feed force (intermittent) (N)			2624		3838	5315	5700	5700
Max. Gear Hole "A"			6		6	4	6	4
Number of stages	0 ²	1	2	2	3	3	4	4
Max. efficiency gearhead incl.screw (%)	93	84	75	75	68	68	61	61
Weight (g)	515	530	590	590	655	655	720	720
Average backlash no load (')	0.5°	0.7°	0.8°	0.8°	0.8°	0.8°	0.8°	0.8°
Mechanical positioning accuracy (mm)	0.039	0.04	0.042	0.042	0.042	0.042	0.042	0.042
Mass inertia gearhead incl.screw (gcm)	113.24	9.92	1.47	0.47	1.41	1.41	1.41	1.41
Gearhead length L1 (mm)	59.9	59.9	68.9	68.9	77.9	77.9	86.9	86.9

1/ based on screw length 201 mm (standard length) 2/ for reduction 1:1=4000rpm For the recommended combination specs, visit AM-36GP.

Download datasheet: <https://assunmotor.com/documents-download>

Visit Our Website and Online Shop at <https://assunmotor.com> Contact: info@assunmotor.com