

AM-BS0802-151-28GP Series

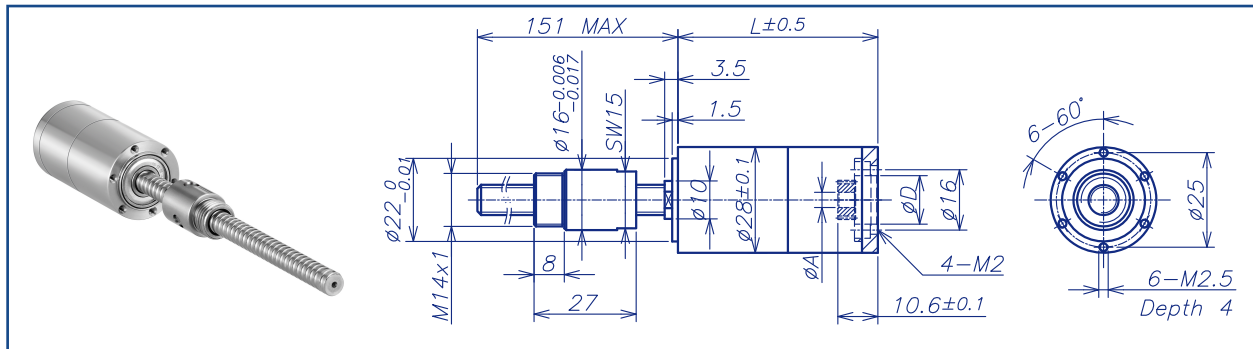

SCREW CHARACTER

Screw	φ 8*2, GCr15, hardened	Radial play (5mm from flange)	< 0.05mm
Standard length	151mm	Axial play	preloaded
Special length (5mm steps)	Max.300mm	Max.continuous input speed	8000rpm
Nut (standard)	thread nut	Recommended Temperature Range	-40°C ~ +100°C
Material	15CrMo, hardened	Max.axial load(static)	1500N
Axial play	< 0.01mm	Number of stages	0 1 2 3 4
Planetary	straight teeth	Max. radial load: (15mm from flange)	200N 200N 350N 400N 400N
Bearing	ball bearing/thrust ball bearing		

SCREW DRIVE DATA

Reduction	1:1	3.4:1	11:1	33:1	38:1	81:1	244:1	465:1
Absolute reduction	1/1	27/8	729/64	529/16	19683/512	5175/64	15625/64	119025/256
Max.feed velocity (mm/s)	150	79	23.4	8.1	6.9	3.3	1.1	0.6
Max.feed force (continuous) (N)	203	251	377	537	565	724	1046	1297
Max.feed force (intermittent) (N)	507	628	941	1343	1412	1500	1500	1500
Max. Gear Hole "A"	4	4	4	3	4	4	4	4
Reduction		4.2:1	14:1		47:1	100:1	301:1	574:1
Absolute reduction		25/6	225/16		6075/128	14375/144	390625/1296	3302625/576
Max.feed velocity (mm/s)		64	19		5.6	2.7	0.9	0.5
Max.feed force (continuous) (N)		269	404		606	776	1122	1391
Max.feed force (intermittent) (N)		673	1010		1500	1500	1500	1500
Max. Gear Hole "A"		4	4		4	4	4	4
Reduction		5.8:1	17:1		59:1	112:1	337:1	642:1
Absolute reduction		23/4	625/36		1875/32	14283/128	43125/128	328509/512
Max.feed velocity (mm/s)		46.4	15.4		4.6	2.4	0.8	0.4
Max.feed force (continuous) (N)		300	433		650	806	1165	1443
Max.feed force (intermittent) (N)		750	1083		1500	1500	1500	1500
Max. Gear Hole "A"		3	4		4	4	4	4
Reduction			19:1		65:1	138:1	377:1	792:1
Absolute reduction			621/32		16767/256	13225/96	385641/1024	304175/384
Max.feed velocity (mm/s)			13.7		4.1	1.9	0.7	0.3
Max.feed force (continuous) (N)			450		675	864	1209	1500
Max.feed force (intermittent) (N)			1124		1500	1500	1500	1500
Max. Gear Hole "A"			4		4	4	4	4
Reduction			24:1		72:1	190:1	416:1	1093:1
Absolute reduction			575/24		15625/216	12167/64	359375/864	279841/256
Max.feed velocity (mm/s)			11.1		3.7	1.4	0.6	0.2
Max.feed force (continuous) (N)			482		697	962	1249	1500
Max.feed force (intermittent) (N)			1206		1500	1500	1500	1500
Max. Gear Hole "A"			4		4	3	4	3
Number of stages	0 ²	1	2	2	3	3	4	4
Max. efficiency gearhead incl. screw (%)	+%	84	75	75	68	68	61	61
Weight (g)	240	240	265	265	295	295	325	325
Average backlash no load (´)	0.7»	0.9»	1»	1»	1.1»	1.1»	1.1»	1.1»
Mechanical positioning accuracy (mm)	" Z 9"	0.038	" Z 39	" Z 39	" Z 39	" Z 39	" Z 39	" Z 39
Mass inertia gearhead incl. screw (gcm ²)	25.07	2.28	0.4	0.4	0.39	0.39	0.39	0.39
Gearhead length L1 (mm)	48.6	48.6	55.8	55.8	63.0	63.0	70.2	70.2

1/ based on screw length 151 mm (standard length) 2/ for reduction 1:1=4500rpm For the recommended combination specs, visit AM-28GP.

Download datasheet: <https://assunmotor.com/documents-download>

Visit Our Website and Online Shop at <https://assunmotor.com> Contact: info@assunmotor.com