

AM-BS0602-151-19GP Series

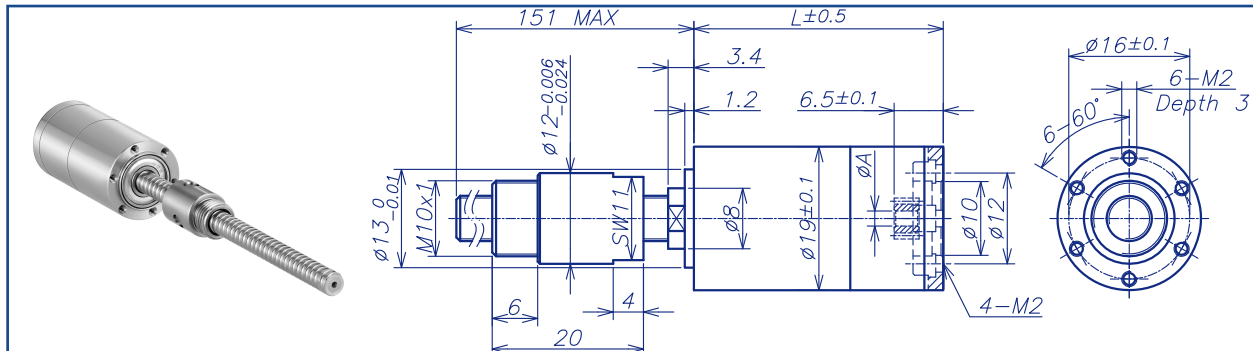

SCREW CHARACTER

Screw	$\phi 6 \times 2$, GCr15, hardened	Radial play (5mm from flange)	< 0.05mm
Standard length	151mm	Axial play	preloaded
Special length (5mm steps)	Max.300mm	Max.continuous input speed	8000rpm
Nut (standard)	thread nut	Recommended Temperature Range	-40°C ~ +100°C
Material	15CrMo, hardened	Max.axial load(static)	500N
Axial play	0	Number of stages	0 1 2 3 4
Planetary	straight teeth	Max. radial load: (15mm from flange)	90N 115N 120N 120N 120N
Bearing	ball bearing/thrust ball bearing		

SCREW DRIVE DATA

Reduction	1:1	3.8:1	14:1	29:1	53:1	* +:1	198:1	455:1
Absolute reduction	1/1	15/4	225/16	729/25	3375/64	& (#) / \$	50625/256	500211/10985
Max.feed velocity (mm/s)	150	71.1	19.0	9.1	5.1	%	1.3	0.6
Max.feed force (continuous) (N)	77	99	154	197	239	\$**	372	491
Max.feed force (intermittent) (N)	155	198	308	393	479	500	500	500
Max. Gear Hole "A"	3	3	3	2	3	3	3	2
Reduction		4.4:1	16:1		62:1	# & 1	231:1	561:1
Absolute reduction		57/13	855/52		12825/208	*) \$%* &	192375/832	2368521/4225
Max.feed velocity (mm/s)		60.8	16.2		4.3	\$	1.2	0.5
Max.feed force (continuous) (N)		105	162		252	% "	392	500
Max.feed force (intermittent) (N)		209	325		500	500	500	500
Max. Gear Hole "A"		3	3		3	\$	3	2
Reduction		5.4:1	19:1		72:1	109:1	270:1	690:1
Absolute reduction		27/5	3249/169		48735/676	2187/20	731025/2704	1121931/1625
Max.feed velocity (mm/s)		49.4	13.9		3.7	2.4	1.0	0.4
Max.feed force (continuous) (N)		112	171		266	305	123	500
Max.feed force (intermittent) (N)		224	342		500	500	500	500
Max. Gear Hole "A"		2	2		3	3	3	2
Reduction			20:1		76:1	128:1	316:1	850:1
Absolute reduction			81/4		1215/16	41553/325	2777895/8788	531441/625
Max.feed velocity (mm/s)			13.2		3.5	2.1	0.8	0.3
Max.feed force (continuous) (N)			174		270	322	435	500
Max.feed force (intermittent) (N)			348		500	500	500	500
Max. Gear Hole "A"			3		3	2	3	2
Reduction			24:1		84:1	157:1	370:1	
Absolute reduction			1539/65		185193/2197	19683/125	10556001/28561	
Max.feed velocity (mm/s)			11.3		3.2	1.7	0.7	
Max.feed force (continuous) (N)			183		280	345	458	
Max.feed force (intermittent) (N)			367		500	500	500	
Max. Gear Hole "A"			2		2	2	2	
Number of stages	0 ²	1	2	2	3	3	4	4
Max. efficiency gearhead incl. screw (%)	+%	84	75	75	68	68	61	61
Weight (g)	100	100	110	110	120	120	130	130
Average backlash no load (')	1»	1.2»	1.5»	1.5»	1.5»	1.5»	1.5»	1.5»
Mechanical positioning accuracy (mm)	" Z %	" Z 4	" Z 41	" Z 41	" Z 41	" Z 41	" Z 41	" Z 41
Mass inertia gearhead incl. screw (gcm)	3.44	0.25	0.04	0.04	0.04	0.04	0.04	0.04
Gearhead length L1 (mm)	35	35	39.8	39.8	44.6	44.6	49.4	49.4

1/ based on screw length 151 mm (standard length) 2/ for reduction 1:1=4500rpm For the recommended combination specs, visit AM-19GP.

Download datasheet: <https://assunmotor.com/documents-download>

Visit Our Website and Online Shop at <https://assunmotor.com> Contact: info@assunmotor.com