

AM-BL45100BF Series

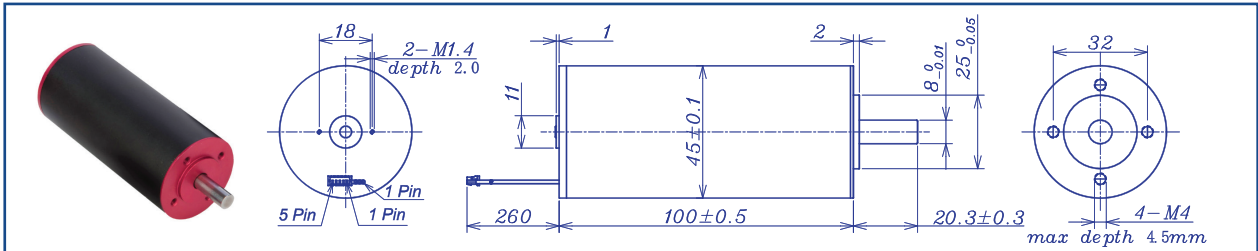

		Brushless Motor		Ball Bearings			
Motor Model		2407	2406	3608	3606	4808	4807
Nominal voltage	V	24	24	36	36	48	48
No load speed	±12% rpm	7569	5823	9200	5684	8200	7075
No load current	Max 150% mA	670	500	700	289	430	350
Recommend limit for continuous operating	Max cont. torque	mN.m	354.79	358.2	234.3	381.69	276.39
	Rated Speed	rpm	6397	5427	8812	5382	7350
	Rated Current	mA	11000	9600	7000	6600	5000
	Rated Power	W	237.68	203.55	216.2	215.12	214.25
Starting current	mA	218182	141176	149904	124138	165517	111628
Stall torque	mN.m	7423	5557	5549	7508	10010	7258
Maximum power output	W	1390.1	847.1	1336.6	1117.2	2149.0	1339.5
Maximum Efficiency	%	90	88	87	91	90	89
Terminal resistance	±12% Ω	0.11	0.17	0.16	0.29	0.29	0.43
Inductance (1KHz)	mH	0.023	0.043	0.035	N/A	0.082	0.13
Mechanical time constant	ms	2.16	2.49	3.9	1.8	1.8	1.71
Moment of inertia	gcm ²	227.14	227.14	227.14	227.14	227.14	227.14
Torque constant	mN.m/A	34.02	39.36	37.2	60.48	60.48	65.02
Speed constant	rpm/V	281	243	257	158	158	147
Speed/torque gradient	rpm/mN.m	0.9	1.0	1.7	0.8	0.8	1
Weight	g	757	757	757	757	757	757

ADDITIONAL INFORMATION			
Motor thermal resistance:	3.3 K/W	Motor thermal time constant:	1740 S
Axial (dynamic):	8.0 N	Radial (5mm from mounting face):	180.0 N
Press-fit force (static):	170 N	Max allowable screw depth into flange:	4.5 mm
Maximum radial play (5mm from mounting face):	≤0.02 mm	Axial play:	0 (<8.0N)
Maximum winding temperature:	155°C	Ambient temperature range:	-30 to 65°C
Standard rear shaft diameter:	8 mm	Standard rear shaft length "L":	0/3.7/5.5 mm

Connection (AWG 18#)	Total Length: L _T =L1+L2+L3				
Cable 1: Yellow Winding A	L1:45GP	L1:52GP	L2:BL45	L3:EN22S	L3:EN36T
Cable 2: Red Winding B	60.1	79.3	100.0	10.7	12.0
Cable 3: Blue Winding C	72.1				
Plug definition (AWG 28#) Molex: 51021-0500					
Plug 1: Brown Hall 3~16V					
Plug 2: Black Hall GND					
Plug 3: Yellow Hall A					
Plug 4: Red Hall B					
Plug 5: Blue Hall C					

Remarks: Client can choose gearbox and encoder to match with this motor. Some combinations are listed here for reference.

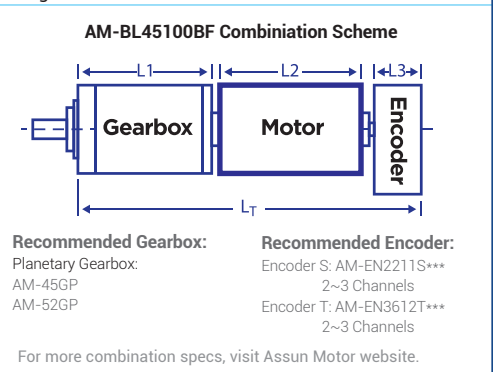

Motor data tested at 25°C. Motor operation exceeding continuous limits will reduce life or result in damage. At elevated ambient temperatures, load current must be reduced.

Download datasheet: <https://assunmotor.com/documents-download>

Visit Our Website and Online Shop at <https://assunmotor.com> Contact: info@assunmotor.com